

# EAST TRADE PARCEL ANNEXATION

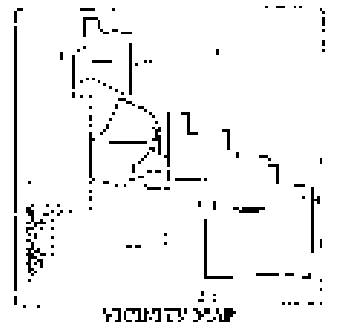
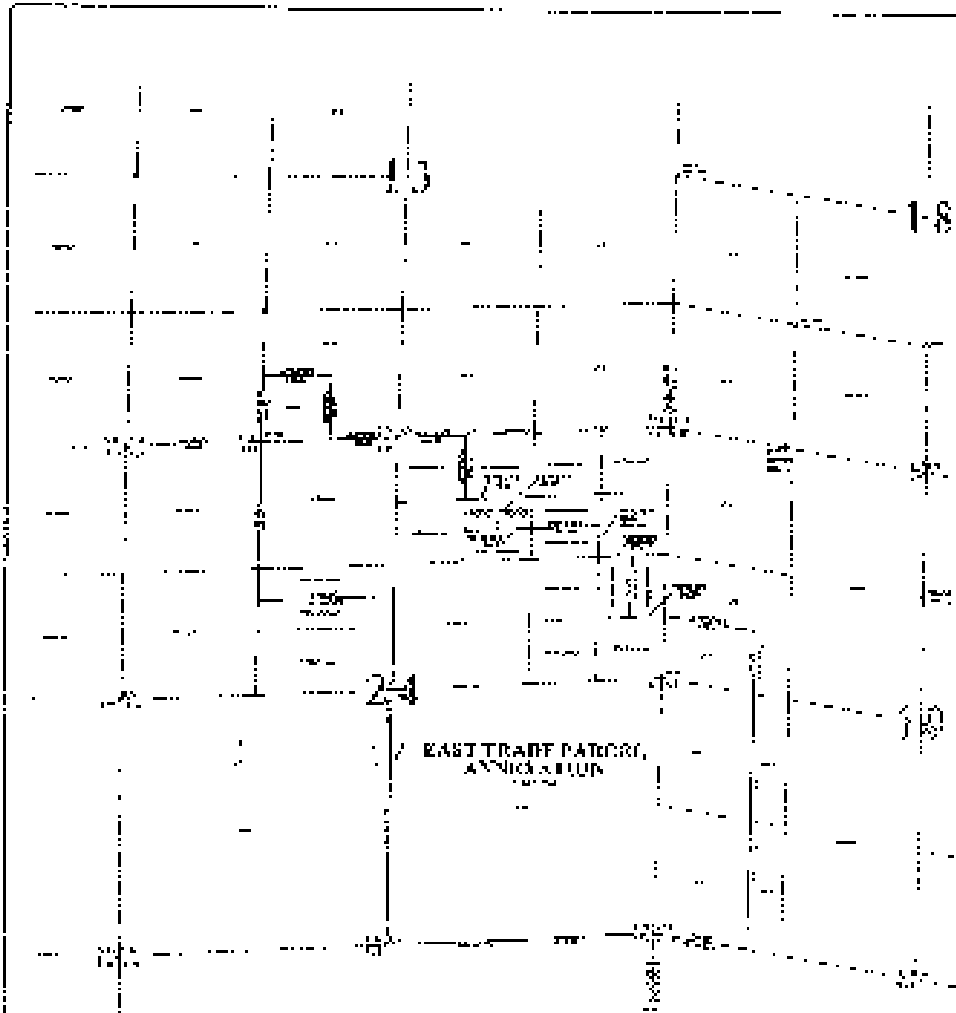

### LEGEND

- PROPOSED ANNEXATION
- EXISTING ANNEXATION
- EXISTING PARCEL
- EXISTING EASEMENT
- EXISTING UTILITY
- EXISTING ROAD
- EXISTING FENCE
- EXISTING CURB
- EXISTING DRIVE
- EXISTING SIDEWALK
- EXISTING BIWAY
- EXISTING TRAIL
- EXISTING FENCE
- EXISTING CURB
- EXISTING DRIVE
- EXISTING SIDEWALK
- EXISTING BIWAY
- EXISTING TRAIL

North



STATE OF MISSISSIPPI  
COUNTY OF WASHINGTON  
SHERIFF'S OFFICE

### REFERENCE

<p>DATE OF RECORDING: 11/11/2024 RECORDED BY: [Name]</p>	<p>OWNER: [Name] ADDRESS: [Address]</p>	<p><b>EAST TRADE PARCEL</b></p>	<p>BOOK: [Number] PAGE: [Number]</p>	<p>APPROVED BY: [Signature]</p>	<p>SCALE: [Scale]</p>
--	---	---------------------------------	--	---------------------------------	-----------------------